



For existing conveyors, the drop-in insert plate design allows for the removal of rollers and ball assembly insert plates to be "dropped-in" and bolted, applies to 1.9" & 1-3/8" roller conveyors.

### Construction:

**Ball assemblies:** 1" diameter steel ball with a 1-3/4" diameter steel housing, 1/4-20 center post mount.

**Insert plates:** 6" x 1" x 12 ga. galvanized channel; bolts into side frames; ball holes punched on 1" centers.

**Capacity:** Ball assembly 75 Lbs. each

| part number   | BF  | Ball Centers | Wt. (l bs.) |
|---------------|-----|--------------|-------------|
| BTI102        | 10" | 2"           | 8.4         |
| BTI103        | 10" | 3"           | 4.8         |
| BTI104 1r o W | 10" | 4"           | 3.6         |
| BTI104 2r o W | 10" | 4"           | 4.8         |

| part number   | BF  | Ball Centers | Wt. (l bs.) |
|---------------|-----|--------------|-------------|
| BTI132        | 13" | 2"           | 10.2        |
| BTI133        | 13" | 3"           | 6.2         |
| BTI134 1r o W | 13" | 4"           | 4.6         |
| BTI134 2r o W | 13" | 4"           | 6.2         |

| part number   | BF  | Ball Centers | Wt. (l bs.) |
|---------------|-----|--------------|-------------|
| BTI162        | 16" | 2"           | 13.3        |
| BTI163        | 16" | 3"           | 7.7         |
| BTI164 1r o W | 16" | 4"           | 5.3         |
| BTI164 2r o W | 16" | 4"           | 6.9         |
| BTI166        | 16" | 6"           | 4.9         |

| part number   | BF  | Ball Centers | Wt. (l bs.) |
|---------------|-----|--------------|-------------|
| BTI223        | 22" | 2"           | 18.2        |
| BTI223        | 22" | 3"           | 10.6        |
| BTI224 1r o W | 22" | 4"           | 7.4         |
| BTI224 2r o W | 22" | 4"           | 9.8         |
| BTI226        | 22" | 6"           | 6.6         |

| part number   | BF  | Ball Centers | Wt. (l bs.) |
|---------------|-----|--------------|-------------|
| BTI273        | 27" | 2"           | 20.6        |
| BTI273        | 27" | 3"           | 12.2        |
| BTI274 1r o W | 27" | 4"           | 7.4         |
| BTI274 2r o W | 27" | 4"           | 10.6        |
| BTI276        | 27" | 6"           | 7.0         |

| part number   | BF  | Ball Centers | Wt. (l bs.) |
|---------------|-----|--------------|-------------|
| BTI362        | 36" | 2"           | 29.6        |
| BTI363        | 36" | 3"           | 17.6        |
| BTI364 1r o W | 36" | 4"           | 11.6        |
| BTI364 2r o W | 36" | 4"           | 15.2        |
| BTI366        | 36" | 6"           | 10.4        |

Insert Capacity (pounds - evenly distributed load)  
(does not include ball capacity)

| 10BF | 13BF | 16BF | 22BF | 27BF | 36BF |
|------|------|------|------|------|------|
| 400  | 375  | 300  | 250  | 175  | 125  |

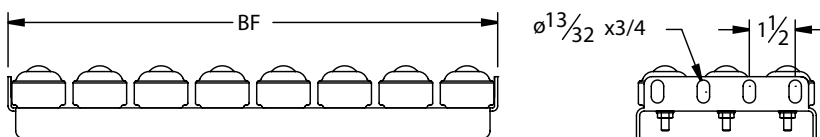
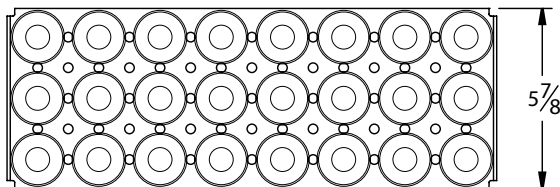

# Ball Transfer

## Ball Transfer units

Ball transfers allow for change of direction and rotation. Ideal for free movement of tools, dies, fixtures, containers, and assemblies. Use where smooth-surfaced items must change direction such as the intersection of two conveyors. Applications include conveyor system ball transfer tables, turntables, sorting tables, cargo decks, feed tables for metal working, die and fixture handling and storage and assembly lines. All ball transfers are sealed and lubricated for long life (except nylon ball). Carbon steel components are zinc plated.

### Threaded Stud Style Ball Transfer units

| Key | Ball Dia. (In.) | Ball Material | Housing Material | Cap. (Lbs.) | Stud Size     | A (In.) | B (In.) | C (In.) | D (In.) | Wt. (Lbs.) | Part No. |
|-----|-----------------|---------------|------------------|-------------|---------------|---------|---------|---------|---------|------------|----------|
| A   | 5/8             | Nylon         | Carbon Stl       | 17          | 1/4-20x1/2    | 13/16   | 15/16   | 5/32    | 1-3/16  | 0.3        | 37809    |
| A   | 5/8             | Carbon Stl    | Carbon Stl       | 33          | 1/4-20x1/2    | 13/16   | 15/16   | 5/32    | 1-3/16  | 0.3        | 25906    |
| A   | 1               | Nylon         | Carbon Stl       | 100         | 5/16-18x3/4   | 1-1/4   | 1-3/8   | 9/32    | 1-43/64 | 0.5        | 37810    |
| A   | 1               | Carbon Stl    | Carbon Stl       | 200         | 5/16-18x3/4   | 1-1/4   | 1-3/8   | 9/32    | 1-43/64 | 0.7        | 25907    |
| B   | 1               | Carbon Stl    | Carbon Stl       | 150         | 3/8-16x11/16  | 1-1/2   | 2-7/16  | 2-3/16  | 5/32    | .4         | 48774    |
| B   | 1-1/8           | Carbon Stl    | Carbon Stl       | 200         | 3/8-16x11/16  | 1-19/32 | 2-7/16  | 2-3/16  | 5/32    | .5         | 48772    |
| B   | 1-1/4           | Carbon Stl    | Carbon Stl       | 250         | 3/8-16x11/16  | 1-3/4   | 2-7/16  | 2-3/16  | 5/32    | .6         | 48773    |
| C   | 1-1/2           | Nylon         | Carbon Stl       | 125         | 3/8-16x1      | 2-5/16  | 3-1/4   | -       | -       | 1.6        | 39049    |
| C   | 1-1/2           | Carbon Stl    | Carbon Stl       | 250         | 3/8-16x1      | 2-5/16  | 3-1/4   | -       | -       | 1.6        | 37817    |
| C   | 1-1/2           | Stainless Stl | Carbon Stl       | 250         | 3/8-16x1      | 2-5/16  | 3-1/4   | -       | -       | 1.6        | 39051    |
| D   | 1               | Carbon Stl    | Carbon Stl       | 150         | 1/4-20x13/32  | 1-7/16  | 1-1/4   | -       | -       | .3         | 48775    |
| D   | 1               | Carbon Stl    | Carbon Stl       | 150         | 5/16-18x11/16 | 1-7/16  | 1-1/4   | -       | -       | .3         | 48776    |
| E   | 1               | Nylon         | Carbon Stl       | 35          | 1/4-20x11/16  | 1-3/8   | 1-3/4   | -       | -       | 0.5        | 24256    |
| E   | 1               | Nylon         | Stainless Stl    | 35          | 1/4-20x11/16  | 1-3/8   | 1-3/4   | -       | -       | 0.5        | 37811    |
| E   | 1               | Carbon Stl    | Carbon Stl       | 75          | 1/4-20x11/16  | 1-3/8   | 1-3/4   | -       | -       | 0.6        | 14038    |
| E   | 1               | Stainless Stl | Stainless Stl    | 75          | 1/4-20x11/16  | 1-3/8   | 1-3/4   | -       | -       | 0.6        | 25904    |
| E   | 1               | Nylon         | Carbon Stl       | 35          | 5/16-18x11/16 | 1-3/8   | 1-3/4   | -       | -       | 0.5        | 37813    |
| E   | 1               | Carbon Stl    | Carbon Stl       | 75          | 5/16-18x11/16 | 1-3/8   | 1-3/4   | -       | -       | 0.6        | 37812    |
| E   | 1               | Stainless Stl | Carbon Stl       | 75          | 5/16-18x11/16 | 1-3/8   | 1-3/4   | -       | -       | 0.6        | 37815    |
| E   | 1               | Stainless Stl | Stainless Stl    | 75          | 5/16-18x11/16 | 1-3/8   | 1-3/4   | -       | -       | 0.6        | 37816    |

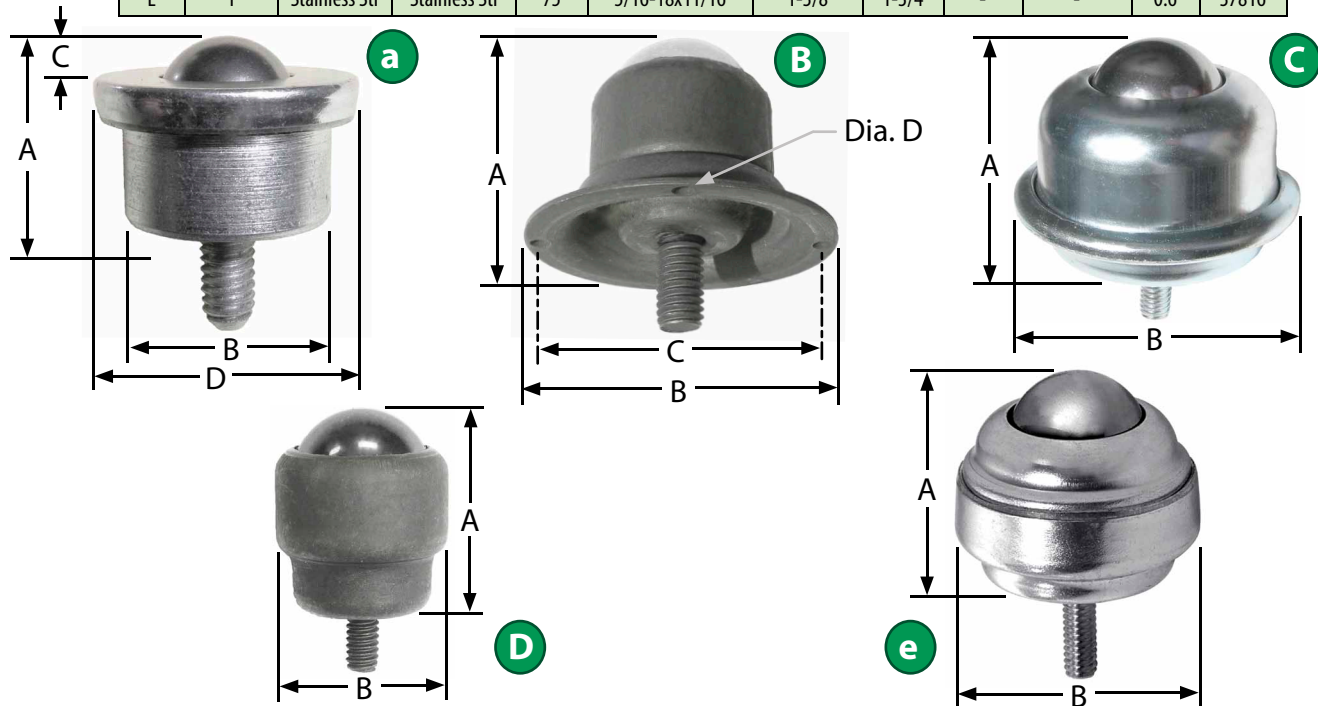

Ball Transfer

### Flange Style Ball Transfer units

| Key | Ball Dia. (In.) | Ball Material | Housing Material | Cap. (Lbs.) | Flange Size (In.) | Flange to Ball A (In.) | B (In.)     | C (In.) | D (In.) | E (In.)    | Wt. (Lbs.) | Part No. |
|-----|-----------------|---------------|------------------|-------------|-------------------|------------------------|-------------|---------|---------|------------|------------|----------|
| F   | 1               | Nylon         | Carbon Stl       | 35          | 2x2-3/4           | 1-3/16                 | 2-3/16      | -       | 7/32    | -          | 0.4        | 22279    |
| F   | 1               | Nylon         | Stainless Stl    | 35          | 2x2-3/4           | 1-3/16                 | 2-3/16      | -       | 7/32    | -          | 0.4        | 37820    |
| F   | 1               | Carbon Stl    | Carbon Stl       | 75          | 2x2-3/4           | 1-3/16                 | 2-3/16      | -       | 7/32    | -          | 0.5        | 14966    |
| F   | 1               | Stainless Stl | Carbon Stl       | 75          | 2x2-3/4           | 1-3/16                 | 2-3/16      | -       | 7/32    | -          | 0.5        | 37819    |
| F   | 1               | Stainless Stl | Stainless Stl    | 75          | 2x2-3/4           | 1-3/16                 | 2-3/16      | -       | 7/32    | -          | 0.5        | 25905    |
| G   | 11/16           | Carbon Stl    | Carbon Stl       | 90          | 2-7/16x1-11/16    | 1                      | 2           | -       | 5/32    | -          | 0.2        | 48767    |
| G   | 1               | Carbon Stl    | Carbon Stl       | 135         | 2-7/16x1-11/16    | 1-9/32                 | 2           | -       | 5/32    | -          | 0.3        | 48768    |
| H   | 1               | Carbon Stl    | Carbon Stl       | 135         | 2-7/16 Dia        | 1-1/2                  | 2-3/16      | -       | 5/32    | -          | 0.4        | 48771    |
| H   | 1-1/8           | Carbon Stl    | Carbon Stl       | 180         | 2-7/16 dia        | 1-19/32                | 2-3/16      | -       | 5/32    | -          | 0.4        | 48769    |
| H   | 1-1/4           | Carbon Stl    | Carbon Stl       | 225         | 2-7/16 Dia        | 1-3/4                  | 2-3/16      | -       | 5/32    | -          | 0.6        | 48770    |
| I   | 11/16           | Carbon Stl    | Carbon Stl       | 90          | 15/16x1-7/32      | 3/4                    | 31/32       | 11/16   | 1/8     | 11/16 Dia  | 0.2        | 48764    |
| I   | 1               | Carbon Stl    | Carbon Stl       | 135         | 1-3/8x1-3/4       | 1-1/16                 | 1-3/8       | 1       | 5/32    | 31/32 Dia  | 0.3        | 48766    |
| I   | 1-1/8           | Carbon Stl    | Carbon Stl       | 180         | 1-3/8x1-3/4       | 1-3/16                 | 1-3/8       | 1       | 5/32    | 31/32 Dia  | 0.4        | 48765    |
| J   | 11/16           | Carbon Stl    | Carbon Stl       | 90          | 1-5/16 Dia        | 3/4                    | 1-1/8 Dia   | -       | 1/8     | 11/16      | 0.2        | 48760    |
| J   | 1               | Carbon Stl    | Carbon Stl       | 135         | 1-23/32 Dia       | 1-1/16                 | 1-15/32 Dia | -       | 5/32    | 31/32 Dia  | 0.3        | 48763    |
| J   | 1-1/8           | Carbon Stl    | Carbon Stl       | 180         | 1-13/16 Dia       | 1-3/16                 | 1-9/16 Dia  | -       | 5/32    | 31/32 Dia  | 0.4        | 48761    |
| J   | 1-1/4           | Carbon Stl    | Carbon Stl       | 225         | 2 Dia             | 1-5/16                 | 1-11/16 Dia | -       | 5/32    | 1-1/16 Dia | 0.5        | 48762    |
| K   | 1-1/2           | Nylon         | Carbon Stl       | 125         | 3x3               | 1-13/16                | 2-19/32     | 2-7/16  | -       | -          | 1.0        | 37821    |
| K   | 1-1/2           | Nylon         | Stainless Stl    | 125         | 3x3               | 1-13/16                | 2-19/32     | 2-7/16  | -       | -          | 1.0        | 37823    |
| K   | 1-1/2           | Carbon Stl    | Carbon Stl       | 250         | 3x3               | 1-13/16                | 2-19/32     | 2-7/16  | -       | -          | 1.4        | 25912    |
| K   | 1-1/2           | Stainless Stl | Carbon Stl       | 250         | 3x3               | 1-13/16                | 2-19/32     | 2-7/16  | -       | -          | 1.4        | 37822    |
| K   | 1-1/2           | Stainless Stl | Stainless Stl    | 250         | 3x3               | 1-13/16                | 2-19/32     | 2-7/16  | -       | -          | 1.4        | 25913    |
| L   | 1-1/2           | Carbon Stl    | Carbon Stl       | 250         | 3x3               | 2-1/32                 | 2-19/32     | 2-7/16  | -       | -          | 1.5        | 37824    |
| L   | 1-1/2           | Stainless Stl | Stainless Stl    | 250         | 3x3               | 2-1/32                 | 2-19/32     | 2-7/16  | -       | -          | 1.5        | 37825    |

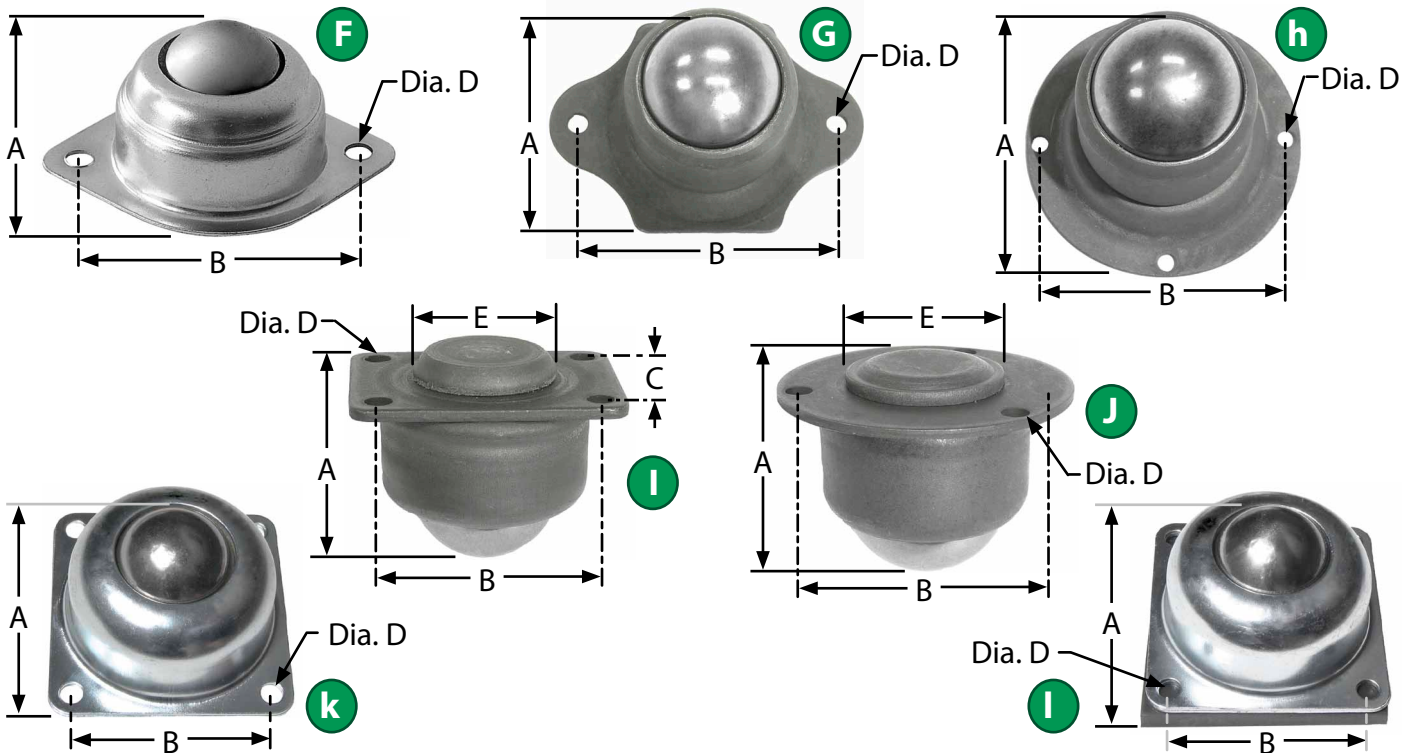

Ball Transfer

# Ball Transfer

## Ball Transfer units

### Countersunk Flange Style Ball Transfer units

| Key | Ball Dia. (In.) | Ball Material | Housing Material | Cap. (Lbs.) | Size (In.)  | Mounting | A (In.) | B (In.) | C (In.) | D (In.) | E (In.) | Ship Wt. | Part No. |
|-----|-----------------|---------------|------------------|-------------|-------------|----------|---------|---------|---------|---------|---------|----------|----------|
| M   | 5/8             | Carbon Stl    | Carbon Stl       | 20          | 1-11/16 Dia | 9/64 dia | 3/8     | 1-11/16 | 1-1/4   | 9/64    | 3/8     | 0.3      | 37830    |
| M   | 1               | Carbon Stl    | Carbon Stl       | 75          | 2-1/4 Dia   | 3/16 dia | 5/8     | 1-7/32  | 1-3/4   | 3/16    | 19/32   | 0.5      | 37831    |
| M   | 1               | Stainless Stl | Carbon Stl       | 75          | 2-1/4 Dia   | 3/16 dia | 5/8     | 1-7/32  | 1-3/4   | 3/16    | 19/32   | 0.5      | 37832    |
| N   | 1               | Nylon         | Carbon Stl       | 35          | 2-3/4X2-1/8 | 7/32 dia | 3/4     | 2-3/4   | 2-3/16  | 3/4     | 31/64   | 0.4      | 37827    |
| N   | 1               | CarbonStl     | Carbon Stl       | 75          | 2-3/4X2-1/8 | 7/32 dia | 3/4     | 2-3/4   | 2-3/16  | 3/4     | 31/64   | 0.6      | 37826    |
| N   | 1               | Stainless Stl | Stainless Stl    | 75          | 2-3/4X2-1/8 | 7/32 dia | 3/4     | 2-3/4   | 2-3/16  | 3/4     | 31/64   | 0.6      | 37829    |

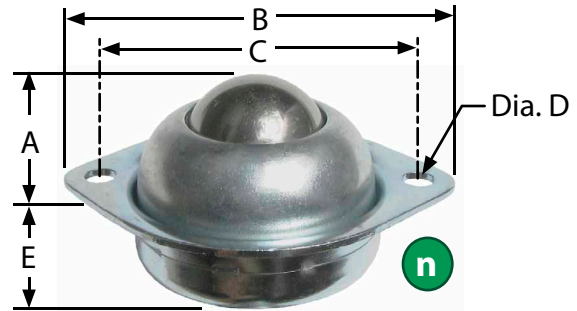
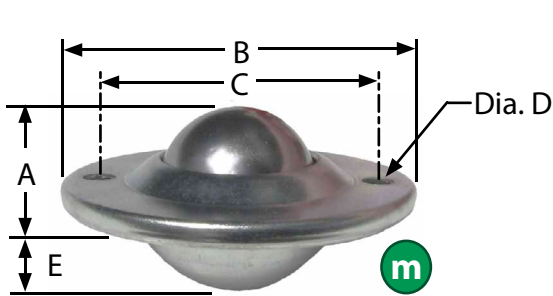

### Drop-In & pipe Style Ball Transfer units

| Key | Ball Dia. (In.) | Ball Material | Housing Material | Cap. (Lbs.) | A (In.) | B (In.) | C (In.) | D (In.) | Ship Wt. | Part No. |
|-----|-----------------|---------------|------------------|-------------|---------|---------|---------|---------|----------|----------|
| O   | 5/8             | Carbon Stl    | Carbon Stl       | 33          | 13/16   | 15/16   | 3/8     | 1-3/16  | 0.3      | 25910    |
| O   | 1               | Carbon Stl    | Carbon Stl       | 200         | 1-1/4   | 1-3/8   | 5/8     | 1-43/64 | 0.6      | 25911    |
| P   | 1-3/16          | Carbon Stl    | Carbon Stl       | 500         | 1-7/16  | 1-3/4   | 17/32   | 2       | 0.9      | 25909    |
| P   | 1-3/16          | Stainless Stl | Carbon Stl       | 500         | 1-7/16  | 1-3/4   | 17/32   | 2       | 0.9      | 23647    |
| Q   | 1-1/2           | Nylon         | Carbon Stl       | 125         | 3-13/16 | 3       | 1-13/32 | 2-19/32 | 1.7      | 39045    |
| Q   | 1-1/2           | CarbonStl     | Carbon Stl       | 250         | 3-13/16 | 3       | 1-13/32 | 2-19/32 | 1.7      | 39046    |
| Q   | 1-1/2           | Stainless Stl | Carbon Stl       | 250         | 3-13/16 | 3       | 1-13/32 | 2-19/32 | 2.3      | 39047    |

